

INSTALLATION INSTRUCTIONS
DESCRIPTION: Bolt Bullet Cowl Kit
PART NUMBER: 1TP-F83J0-XX
MODEL: Bolt, Bolt R-Spec



DEALER:

These instructions contain important information for future reference and *must* be given to the customer.

⚠WARNING

This accessory should be installed by an authorized Star dealer or a qualified mechanic. Improper installation could result in loss of control and an accident with severe injury or death.

WARRANTY INFORMATION:

- Genuine Star Accessories are covered by a one-year limited warranty against defects in material or workmanship. Labor for replacement of defective components is not covered. See your Yamaha dealer for a copy of the warranty statement.

PARTS LIST:

This kit contains the following components. Before beginning installation, confirm there are no missing or damaged components.

Item	Part Number	Description	Qty
--	1TP-F83J0-XX	Bullet Cowl Kit	--
①	*	Windshield	1
②	*	Bullet Cowl	1
③	*	Countersunk, Hex Socket (M6 x 12mm)	5
④	*	Mount, Right	1
⑤	*	Mount, Left	1
⑥	*	Rear Clamp Bracket	2
⑦	*	Rubber Bushing	4
⑧	*	Rubber Washer	5
⑨	*	Cap Washer	5
⑩	*	Center Knob	1
⑪	*	Cap Nut (M6)	4
⑫	*	Carriage Bolt (M6 x 16mm)	4

* Part supplied with kit only and not available separately.

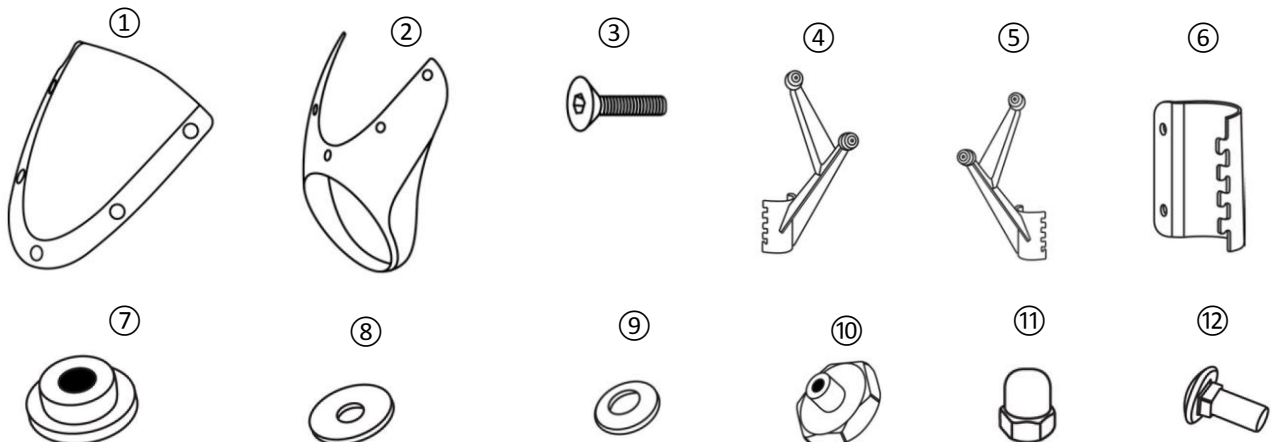

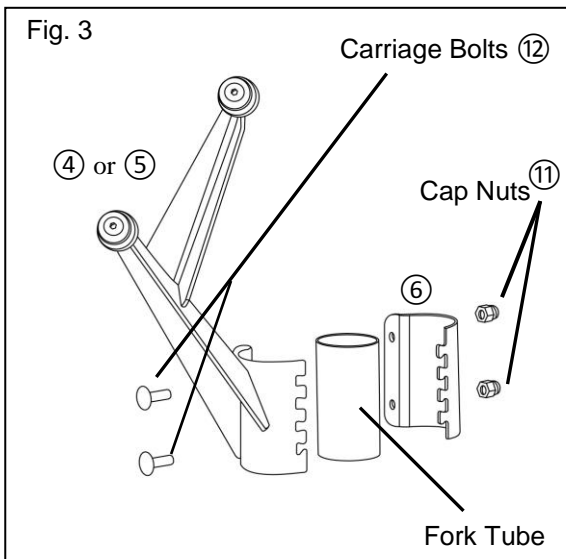
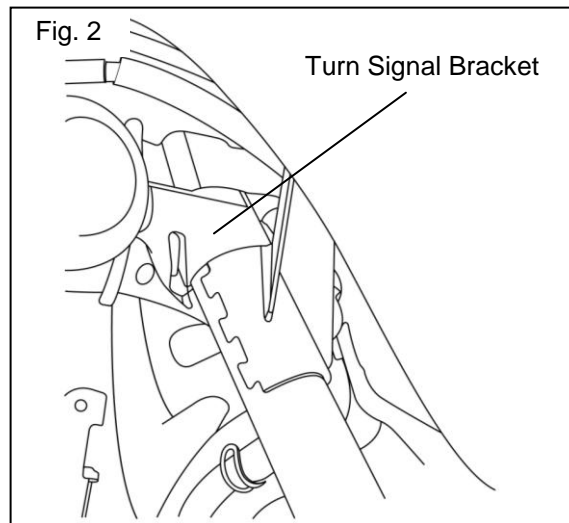
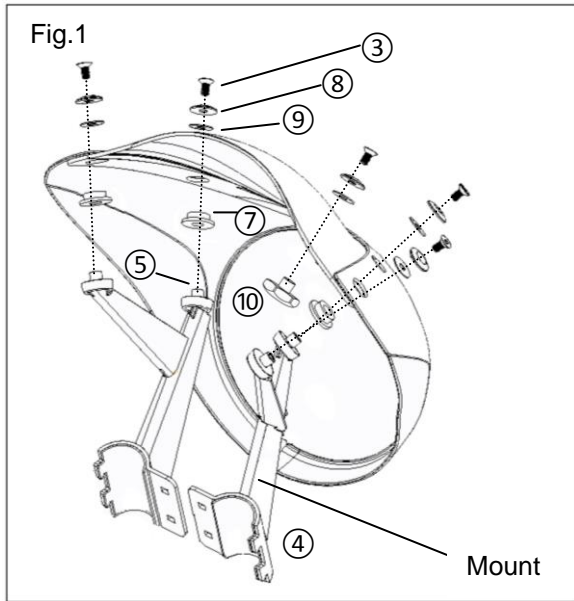

PREPARATION:

1. Place motorcycle on a secure and level surface.
2. Clean all mounting surfaces before beginning installation.

INSTALLATION:

1. The cowl is pre-assembled. Hold the bullet cowl against the fork tubes and slide it up until the mounts contact the turn signal brackets as shown in (Fig. 2).
2. Install the rear clamp brackets ⑥ behind the fork tubes using four carriage bolts ⑫ and four cap nuts ⑪ as shown (Fig. 3). Two bolts and nuts per side. When properly positioned, snug the cap nuts but do not tighten completely at this time.
3. Take time to center the cowl around the headlight. If the cowl is not centered, slide and rotate the mounts on the fork tubes to center the cowl.
4. Evenly torque the 4 carriage bolts and cap nuts to 10 Nm (1.0 m·kg, 7.2 ft·lb).
5. Check the headlight for proper operation.

MAINTENANCE:

Periodically, check tightness on all hardware.

CARE AND CLEANING:

Wash using a mild soap and water solution and a soft cloth.

CUSTOMER SERVICE:

For further information, see your Yamaha dealer.

ESTIMATED TIME TO INSTALL: 0.5 HRS